

# BS88, IEC269 Industrial HRC Fuse Links

## Centre Bolted Tags 415V ac and 550V ac for Motor Rated

EF

### Time-Current Characteristic Curves

Non Motor Rated

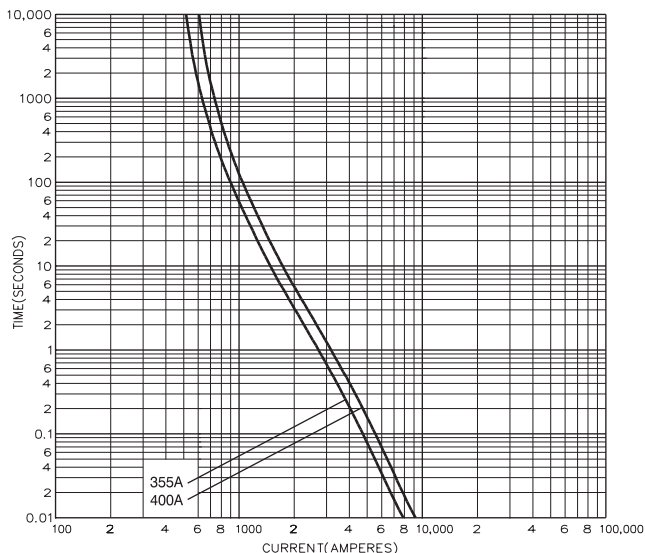

Motor Rated

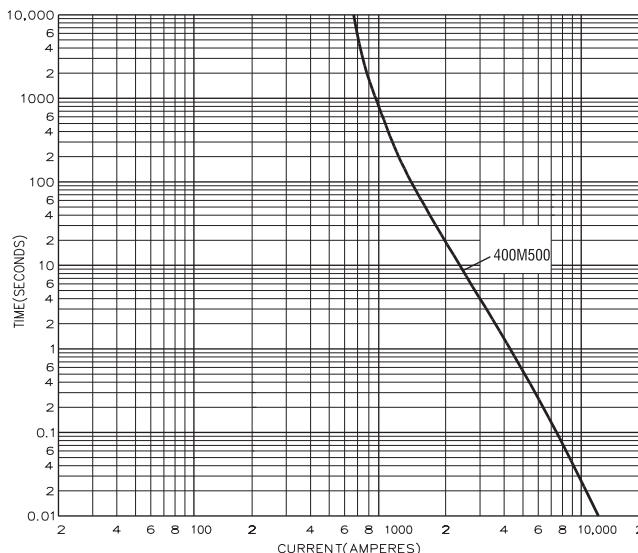

### Dimensional Data

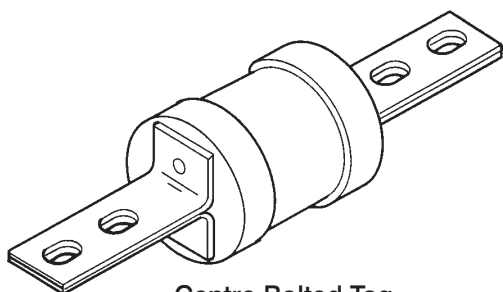

Centre Bolted Tag

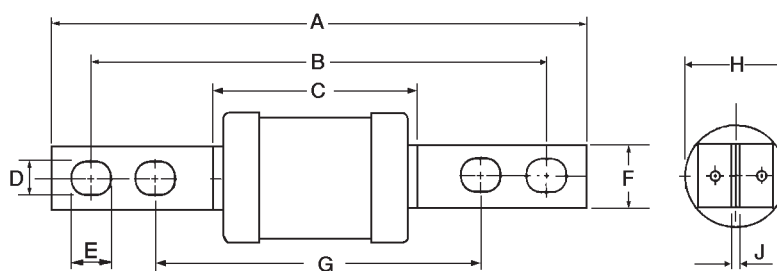

Catalog Number	I <sup>2</sup> t (Amps <sup>2</sup> Secondsx 10 <sup>3</sup> )			Nom. Watts Loss	Rated Voltage	Dimensions (mm)								
	Amp Ratings	Pre-Arcing	Total at 415V			A	B	C	D	E	F	G	H	J
EF355	355	360	865	24	415 ac	209.0	184.0	50.0	10.5	12.5	25.4	133.0	38.0	4.7
EF400	400	475	1,150	29		210.0	187.0	75.0				15.5	136.0	
EF400M500	400M500	1,200	2,700	27	550 ac	210.0	187.0	75.0	15.5	25.4	136.0	59.0	4.7	

Packaging - 1 per carton

This bulletin is intended to clearly present comprehensive product data and provide technical information that will help the end user with design applications. Bussmann reserves the right, without notice, to change design or construction of any products and to discontinue or limit distribution of any products. Bussmann also reserves the right to change or update, without notice, any technical information contained in this bulletin. Once a product has been selected, it should be tested by the user in all possible applications.

**Bussmann Division**  
**Cooper (U.K.) Ltd**  
 Burton-on-the-Wolds  
 Leicestershire, LE12 5TH  
 United Kingdom  
 Tel: (44) (0)1509 88 27 37  
 Fax: (44) (0)1509 88 27 86

Head Office  
 St. Louis, MO, U.S.A. Tel: (314) 527-3877 Fax: (800) 544-2570 International Fax: (314) 527-1445



Bussmann Information Fax (00 1) 314 527 1450  
 Bussmann WEB site - <http://www.bussmann.com>

A COOPER Industries Company